

1:5000 @ A1

LEGEND

- PROPOSED LAND TREATMENT AREA BOUNDARY
- POTENTIAL FUTURE LAND TREATMENT AREA BOUNDARY OR PROPERTY BOUNDARY
- BUFFER ZONE
- 10m BUFFER ZONE TO BE PLANTED
- EXISTING WILLOWS BUFFER TO BE ENHANCED
- PROPOSED LAND TREATMENT USING BORDER STRIP IRRIGATION METHOD

NOTE:
 PLANTED BUFFER ZONES TO BE PROVIDED AROUND THE WEST BOUNDARY OF THE POTENTIAL FUTURE LAND TREATMENT AREA WHERE AGREED BY THE ADJACENT RESIDENTS

POTENTIAL FUTURE LAND TREATMENT AREA

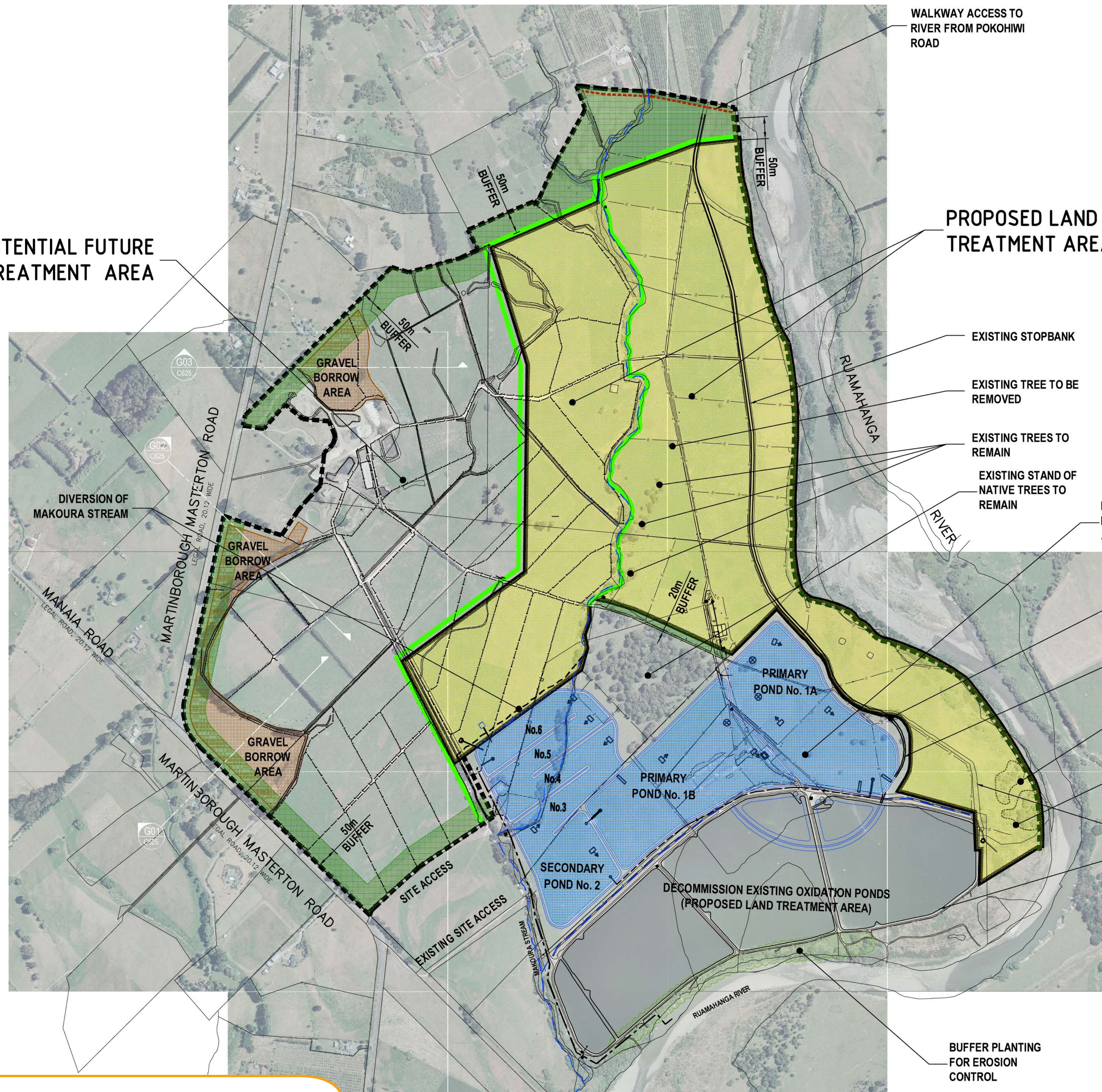

WALKWAY ACCESS TO RIVER FROM POKOHIWI ROAD

PROPOSED LAND TREATMENT AREA

EXISTING STOPBANK

EXISTING TREE TO BE REMOVED

EXISTING TREES TO REMAIN

EXISTING STAND OF NATIVE TREES TO REMAIN

EXISTING TREES IN PROPOSED POND AREA TO BE REMOVED

EXISTING TREES TO REMAIN

NEW STOPBANK ALIGNMENT. MERGE INTO NEW POND BANK AND LINK TO SLUDGE LANDFILL BANK

EXISTING TREES TO BE REMOVED

EXISTING TREES TO REMAIN

EXISTING STOPBANK AND POND BANKS TO BE REMOVED

BUFFER PLANTING FOR EROSION CONTROL